

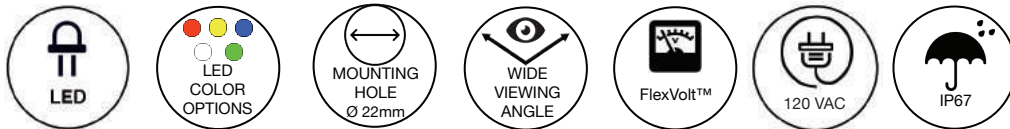

CNX722 Series 0.866" (22mm) Ruggedized LED Panel Mount Indicator



Ruggedized CNX722 Series with built-in LED offers fast, easy installation in harsh environments.



Applications

- Industrial Machinery
- Transportation Dashboards
- Instrument Panels
- Control Cabinets
- Safety Applications
- Disinfection and Sterilization
- Switching Stations
- Slot, Gaming and Vending Machines
- Outdoor Signs
- Military Aircraft

Key Features

- For panel hole diameter: 0.866" (22mm)
- Designed for extreme harsh and outdoor environments.
- Variety of connection options for fast, easy installation.
- Built-in LED can be used with FlexVolt™ (5 to 28 VDC) or 120VAC circuits
- Fast pitch threads ease assembly, requiring only one turn.
- Nut assembly by finger-tightening or with 1 inch hex key.
- RoHS and REACH Compliant.
- Outdoor visibility in direct sunlight.
- Available in six solid colors (red, green, white, blue, soft yellow and yellow).
- Wide Viewing Angle
- Resistant to shock and vibration.
- Optional bezel available in many colors
- Moisture sealed, IP67, protected from total dust ingress and withstanding water immersion between 15 cm and 1 meter for 30 minutes.
- Lead wire options with custom wire length available.
- Other colors (single and bicolor) are available upon request.

Ordering Data

The CNX722 Series is available in a range of standard features and options. To specify your Panel Mount Indicator, select one option from each column.

| LED Color | | Voltage | | Termination Style | |
|--------------------------|-------------|---------|---------|-------------------|--------------------------------|
| CNX722C | | | | | |
| CNX722C: Colored Body | | | | | |
| 200 | Red | FV | 5-28VDC | B* | Screw Block |
| 400* | Soft Yellow | | | W | Wire Leads |
| 401 | Yellow | | | T | Quick Disconnect/ Terminals |
| 500 | Green | | | | |
| 600 | Blue | | | | |
| 900 | White | | | | |
| | | 120 | 120VAC | | |

Example:
CNX722C401120T
Yellow
120V
Quick Disconnect



* Not Available for the 120VAC Version

Accessories

Optional sealed bezel: BZL722-□

Sealed Bezel IP67

- Material - either plastic or metal
- For indoor and outdoor applications, protects against falling dirt. Also protects against water or oil and the effects of ice formation.

| | |
|---------------|----------------|
| moisture seal | EPDM |
| bezel-plastic | ABS, UL 94-HB |
| bezel-metal | aluminum alloy |

| Bezel Color | | Material |
|-------------|------------------|----------|
| □ | color | |
| 0 | black | plastic |
| 2 | red | plastic |
| 4 | yellow | plastic |
| 5 | green | plastic |
| 6 | blue | plastic |
| 9 | white | plastic |
| A | actual aluminum | metal |
| B | brushed aluminum | plastic |
| C | chrome | plastic |

Example:
CNX722C900FVW
White
with BZL722-A
Actual Aluminum
Bezel

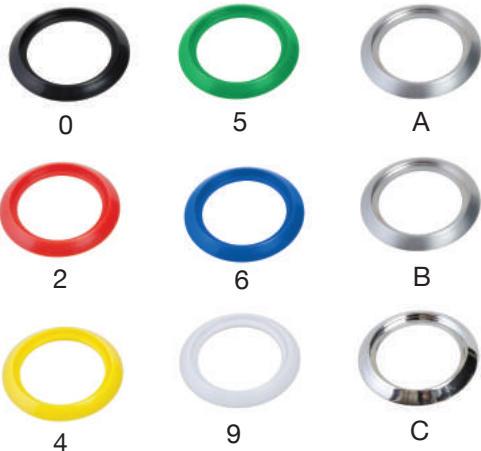

Product Dimensions

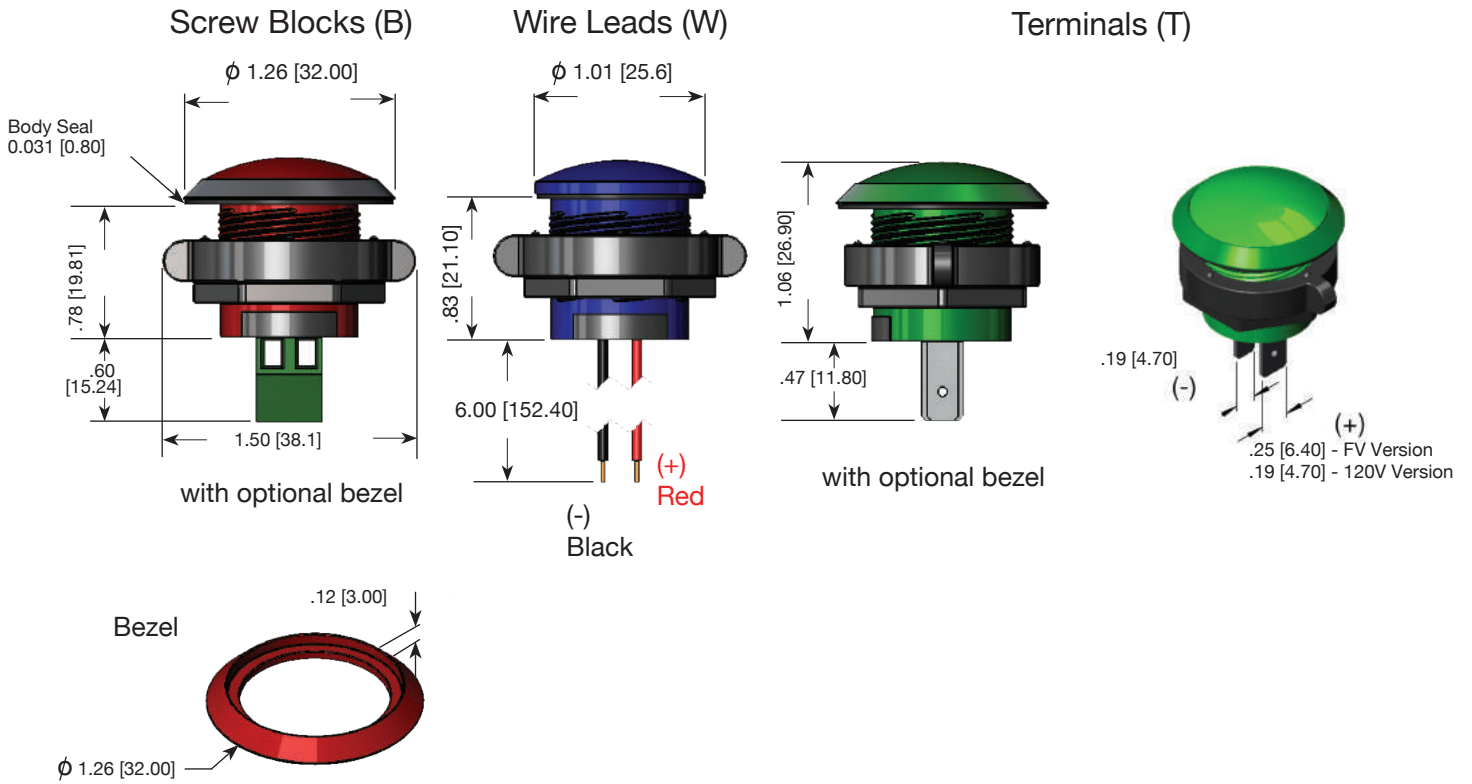

Recommended Mounting Hole

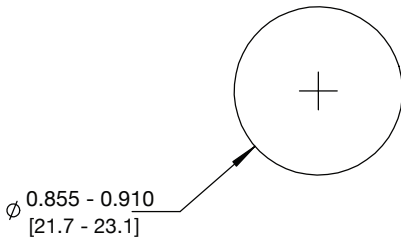

All Dimensions in inches [mm]

Product Specifications

Flex Voltage Version:

| LED output | | |
|-------------|--------------------------|--------|
| LED color | Luminous intensity (mcd) | I (mA) |
| red | 1300-2700 | 20 |
| soft yellow | 80-400 | 20 |
| yellow | 450-1120 | 20 |
| green | 1000-1400 | 20 |
| blue | 280-710 | 20 |
| white | 1300-1800 | 20 |

120VAC Version:

| LED output | | |
|------------|-------------------------------|--------|
| LED color | Luminous intensity typ. (mcd) | I (mA) |
| red | 550 | 8 |
| yellow | 245 | 8 |
| green | 924 | 8 |
| blue | 67 | 8 |
| white | 644 | 8 |

Installation Specification

| | |
|-----------------|----------------------------------|
| mounting hole | 0.855-910" (21.7-23.1mm) |
| panel thickness | Up to .300" (7.6mm) |
| spacing | minimum 1.5" center to center |
| retainer width | 1.50" (38.1 mm) |

Operating parameters

| | |
|-----------------------|----------------------------------|
| operating temperature | -40°F (-40°C) to 176°F (80°C) |
|-----------------------|----------------------------------|

Materials

| | |
|---------------|---|
| body | polycarbonate, UL94-V2 |
| retaining nut | PBT/Glass Filled, UL94-V0 |
| wire | 22 AWG - Black/Red** 18 AWG - Black*** |
| lens | polycarbonate, UL94-V2 |
| moisture seal | EPDM |

** Flex Voltage Version

*** 120 VAC Version

Compliance and Approvals

