

# VBL Series

## Ø 0.118 (3mm) PCB Mounted Light Pipe for Surface Mount LED

VBL Series features vertical press-fit board mount LED light pipes available in a range of different lengths with either a flat or a domed top.

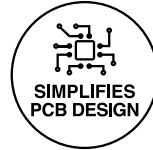
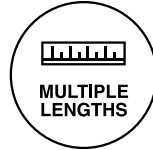
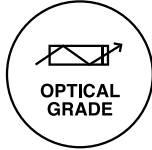

### Applications

- Audio/Video
- Industrial Robots
- Darkroom Equipment
- Agriculture
- Entertainment
- Medical
- IoT
- Data Center Solutions
- Transportation Power Systems

### Key Features

- Rigid board mount light pipe for surface mount LEDs
- 3mm round lens with either a domed or flat face
- The VBL light pipes are mounted onto the PCB using push-fit lugs in close proximity to the LED
- Features a press-fit installation into the PCB board which simplifies installation and enables faster assembly
- Protects LED from ESD
- Optical grade PMMA for maximum light transmission
- Frosted surface diffuses light and provides uniform brightness and a soft glow
- Operating temp: Max 194F(90°C)
- Standard lengths from 0.20 to 1.000
- For custom length contact VCC
- RoHS and REACH Compliant

# Ordering Data

Series	Diameter	Shape	Overall Length	Color
VBL	3	D	0200	C
	3   3mm	D   Dome F   Flat	0200   .2 (5.1mm) 0250   .25 (6.4mm) 0300   .3 (7.6mm) 0350   .35 (8.9mm) 0400   .4 (10.2mm) 0450   .45 (11.4mm) 0500   .5 (12.7mm) 0550   .55 (13.9mm) 0600   .6 (15.2mm) 0700   .7 (17.8mm) 0800   .8 (20.3mm) 0900   .9 (22.8mm) 1000   1.0 (25.4mm)	C   Clear

\*Custom lengths available upon request



Example:

VBL3D0900C

VBL Series, PCB mount, .9 (22.8mm) Overall Length, Dome Shape, Clear

# Product Dimensions

## VBL Series

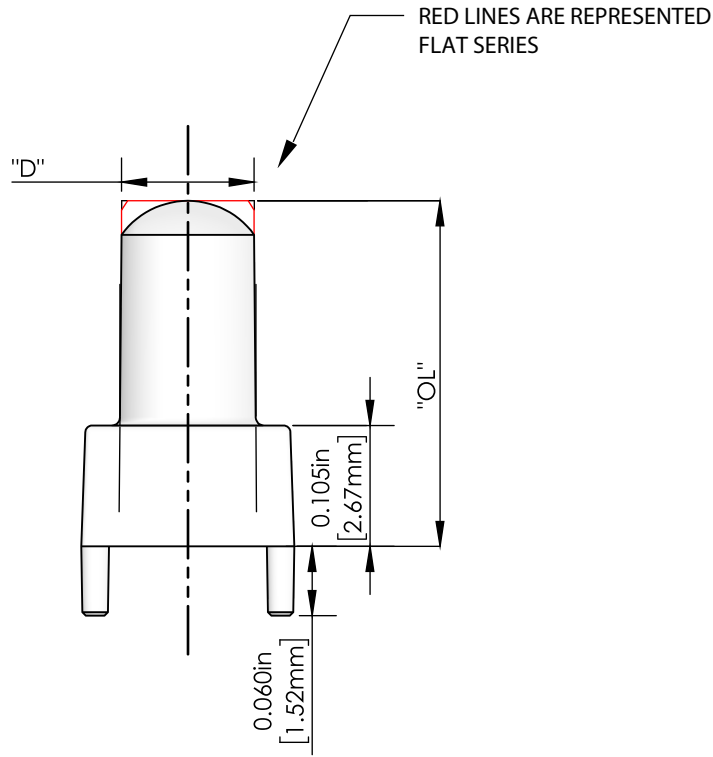

Overall Length (OL)
.2 (5.1mm)
.25 (6.4mm)
.3 (7.6mm)
.35 (8.9mm)
.4 (10.2mm)
.45 (11.4mm)
.5 (12.7mm)
.55 (13.9mm)
.6 (15.2mm)
.7 (17.8mm)
.8 (20.3mm)
.9 (22.8mm)
1.0 (25.4mm)

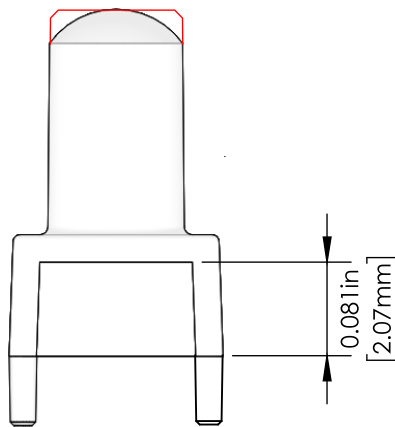

### Mounting Hole Pattern

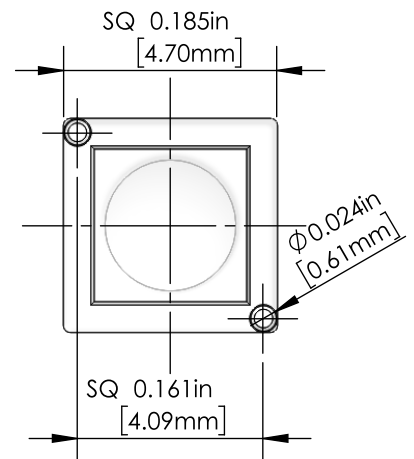

#### Notes:

1. All dimensions are in inches [millimeters]
2. The specifications, characteristics and technical data described in the datasheet are subject to change without prior notice.

## Product Specifications

Materials	
Body	PMMA, Optically clear

Installation Specifications	
Diameter	Ø 0.117 ± 0.002
Standard Lengths	.2 to 1.0 (5.1mm to 25.4mm)

Temperature Specifications	
Operating Temperature	Max 194F(90°C)

## Compliances and Approvals

