

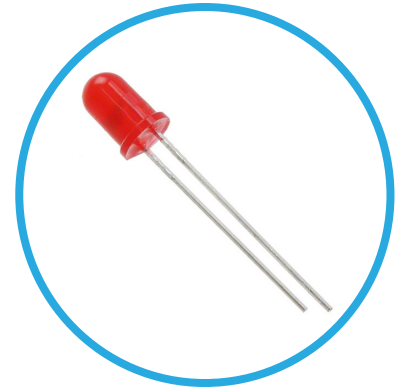

4302H Series T-1 3/4 (5mm) Integrated Resistor 5 Volt and 12 Volt Operation



A T-1 3/4 (5mm) thru-hole LED with integral current limiting resistor.
Available in red, amber or green color with a 60 degree viewing angle

Key features

- Available in colors Red, Green and Amber
- Integral current limiting resistor
- TLL compatible-requires no external current limiting resistor, will operate off 5 volt or 12 volt supply
- Cost effective-saves valuable board space, resistor and assembly cost
- Compliant with RoHS and REACH requirements

Product Dimensions

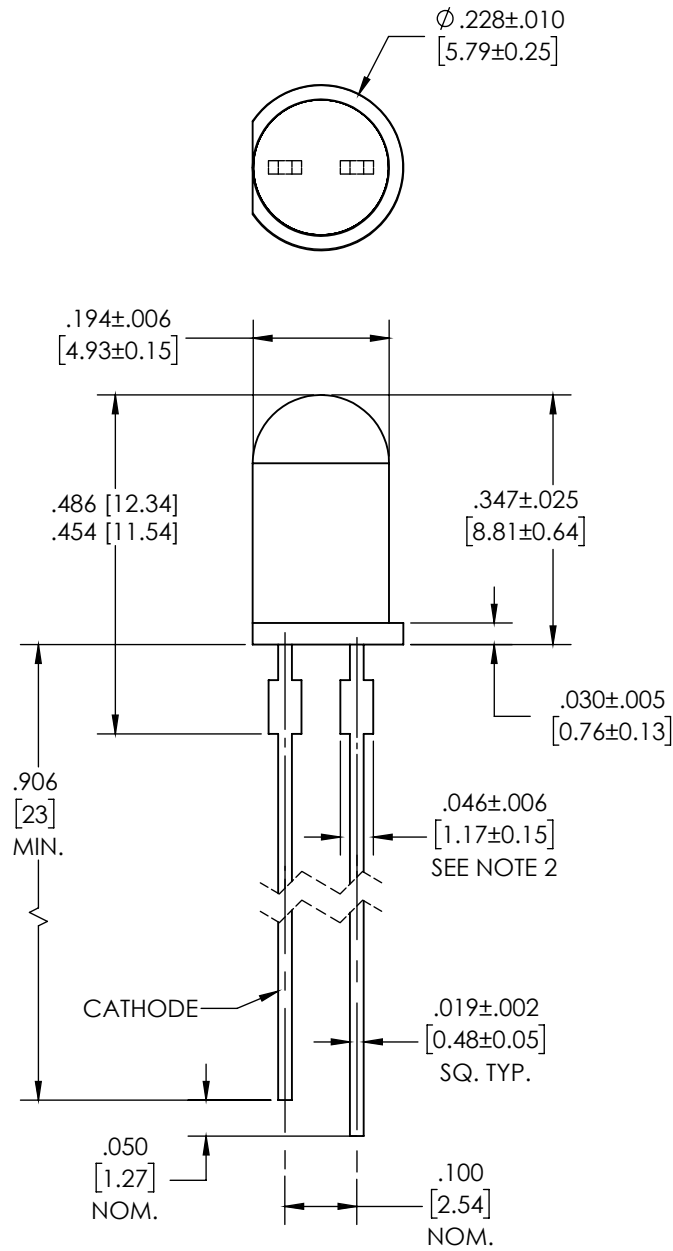

Notes:

1. All dimensions are in inches [millimeters]
2. For LEDs Red and Green the dimension of the tabs are $.021" \pm .002"$. This apply to 5V and 12V version

Product Specifications

Part Number	4302H1-5V	4302H3-5V	4302H5-5V	4302H1-12V	4302H3-12V	4302H5-12V
Output Color	Red	Amber	Green	Red	Amber	Green
Diffusion	Diffused	Diffused	Diffused	Diffused	Diffused	Diffused
Package Color	Red	Amber	Green	Red	Amber	Green
Rated Current (mA)	10	10	12	13	13	13
Forward Voltage Typ.(V)	5	5	5	12	12	12
Forward Voltage Max.(V)	7.5	7.5	7.5	15	15	15
Luminous Intensity Min.(mcd)	2	2.2	2	2	2.2	2
Luminous Intensity Typ.(mcd)	8	-	8	8	-	8
Luminous Intensity Max.(mcd)	-	-	-	-	-	-
Peak Wavelength (nm)	635	583	565	635	583	565
Viewing Angle 2 θ 1/2 (degrees)	60	60	60	60	60	60
Continuous Forward Current Max (mA)	15	15	15	20	20	20
Reverse Breakdown Voltage Min. (V)	5	5	5	5	5	5
Operating Temperature (°C)	-40 to 85	-40 to 85	-20 to 85	-40 to 85	-40 to 85	-20 to 85

Compliances and Approvals

