



2110A, 2111A, 2112A, 2113A Series Non-Relampable Ø.310” Panel Mount Indicator



Description and Features

Mounting: Ø.310” MIN., supplied with push-on speednut 8700091652

Wire Leads: No. 22 AWG (105°C) 4.40”/4.80” long, stripped .430”/.570”

Lens: Polycarbonate-neon transparent, incandescent-translucent

Housing: White Nylon. For Black Nylon, add “X” after A, for example: 2110AX3

Underwriters Laboratories (UL) File No.E20356

Ordering Data

Lens Color	Neon	
	Model No. (105-125VAC)	Model No. (208-250VAC)
Red	2110A1	2111A1
Clear	2110A2	2111A2
Amber	2110A3	2111A3
White	2110A4	-
Green	2112A5*	2113A5*
Blue	2112A6**	2113A6**
Lamp Used	C2A+Resistor	C2A+Resistor
Lead Color	Black	Black/Red

* Incorporates G2B lamp and resistor.

** Incorporates T2B lamp and resistor.

Product Dimensions

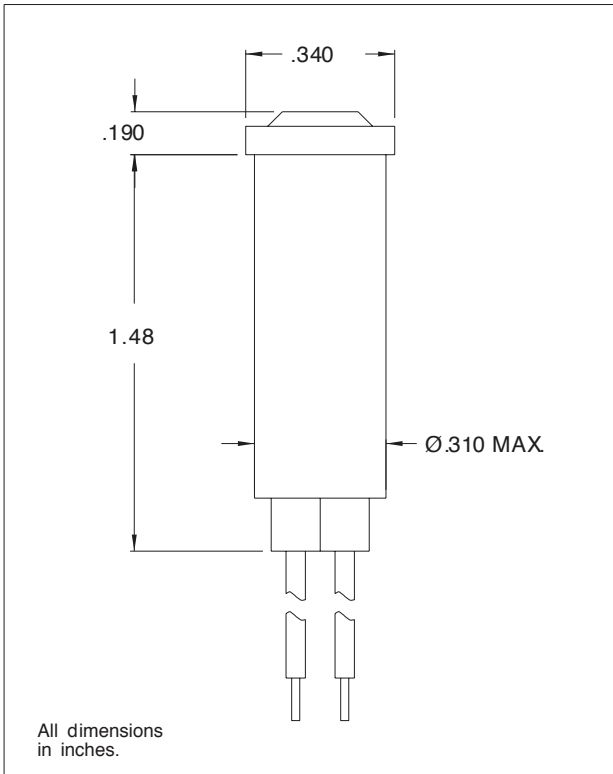

Speed Nut 8700091652

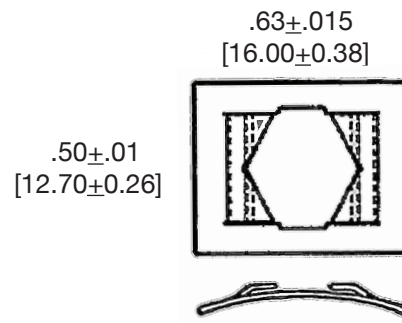

Dimensions in inches [mm]

Compliances and Approvals

