

4000/3000 Series T1 Panel LED

Special Features

- One piece body and lens construction – available in red, green, blue, amber and clear butyrate plastic
- Front mounting ribbed body “snaps into panel”– no mounting hardware required
- Available in smooth body for thinner panels – mounts with tinnerman nut
- Optional internal resistor- can be customized for AC applications
- Wide selection of wire sizes and types – including Mil Spec MIL-W-22759/33 wire
- Sealed against moisture and dust to meet IP66

Specifications

- Mounting hole: .187” ± .001” (4.75 ± .03 mm)
- Termination: 26 AWG UL1061 6.0” (152.4mm) red (anode) and black (cathode) leads stripped to .250” (6.35 mm) standard or LED pins
- Housing: Butyrate plastic

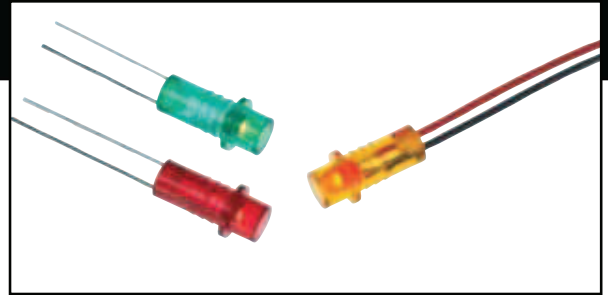

3mm Panel Mount LED Assemblies

Package Dimensions

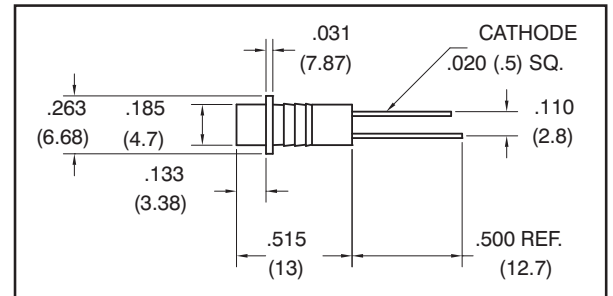

All dimensions are in inches (mm)

Electrical and Optical Characteristics (TA = 25°C)

LED Part #	Color	Luminous Intensity (mcd) Typ. @ I _f (mA)		V _f Typ. @ I _f (mA)		Viewing Angle 2θ ½	Peak Wavelength (nm)
HIGH EFFICIENCY							
1300	Yellow	6.0	10	2.0	10	60°	583
1301	Red	5.5	10	1.9	10	60°	635
1302	Green	5.0	10	2.1	10	60°	565
1313	Orange	5.5	10	1.9	10	60°	600
LOW CURRENT (Use -0001 for resistor code)							
1303	Red	2.1	2	1.7	2	50°	635
1304	Yellow	2.1	2	1.8	2	50°	583
1305	Green	2.3	2	1.9	2	50°	565
BICOLOR (2 leaded)							
8901	Red	20.0	20	2.0	20	60°	627
	Green	16.0	20	2.2	20		565
8903	Yellow	7.0	20	2.1	20	60°	590
	Green	16.0	20	2.2	20		565
BLUE							
8310	Blue	1100	20	3.3	20	30°	468
ULTRA BRIGHT							
1310	Red	55.0	20	1.9	20	45°	635
1311	Yellow	45.0	20	2.1	20	45°	583
1312	Green	45.0	20	2.2	20	45°	565
1315	Red	45.0	20	1.8	20	60°	645
SUPER ULTRA BRIGHT							
8306	Green	150.0	20	2.2	20	50°	565
8312	Yellow	700.0	20	2.0	20	50°	590
8313	Red	800.0	20	1.85	20	50°	660
WHITE							
1331	White	1600	20	3.3	20	34°	N/A

Resistor Chart

OPERATING SPECIFICATIONS				
Resistor Value Code	Voltage	Current (mA)	Resistor Value (Ohms) Green, Yellow Red, Bicolor LED	Resistor Value (Ohms) Blue, White LED
0000	2	10 or 20	None	Not Available
9900	5	10	332	
9928	5	10		121
9901	12	10	1000	
9902	12	10		715
9903	24	10	2210	
9904	24	10		1910
9905	28	10	2610	
9906	28	10		2320
9907	5	20	150	
9922	5	20		65
9908	12	20	511	
9909	12	20		357
9910	24	20	1100	
9911	24	20		953
9912	48	9	4870	
9913	48	9		4350
9914	60	7	8250	
9915	60	7		7500
9920	120VAC	8	6490	Contact VCC

Note: Bi-Color not available in AC voltages

How To Order

