



Basic snap action microswitch. A precision microswitch for high breaking capacity, the mp40 series offer ip40 protection with screw lugs or solder terminals using a wide range of interchangeable actuators. The switch is ideally suited for industrial applications with its wide operational temperature range and optional low actuating force.

MP40

Approval	EN 61058-1 250VAC/15A 50'000 cycles
	EN 61058-1 400VAC/10A 50'000 cycles
	UL 61058-1 250VAC/15A 50'000 cycles
	UL 61058-1 400VAC/10A 50'000 cycles
	Resistive load
Housing	Plastic reinforced with glass fiber (PBT)
Pin Button	PBT
Switching Circuit	Change over - snap action with blade spring in copper/beryllium
Contact	Silver - optional gold
Connection	Screw, solder lugs, protection cover
Actuator	Stainless steel
Degree of Protection	Housing IP40 Connection IP00 Protection Cover IP20
Class of Protection	II
Micro-switching	μ
Distance between Contacts	0.30 mm
Dimensions	DIN 41 635, form A 49 x 21 x 17 mm
Actuation Force	Between 0.2 to 6.0 N, depending on the lever
Differential Travel	0.05 mm - Optional 0.02 mm
Temperature Range	EN 61058-1 -40°C to +130°C UL 61058-1 -40°C to +130°C
Mechanical Life	50 x 10 ⁶ cycles

Type **0** : Basic switch - Pin Button

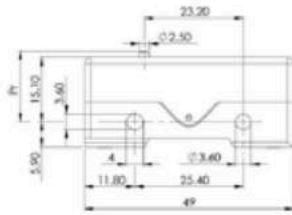
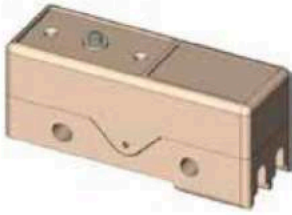

Actuating Force Fa max. (N)	5.0
Release Force Fr min. (N)	2.5
Free Position Pr (mm)	16.3 ± 0.5
Operating Position Pa (mm)	15.9 ± 0.3
Over-Travel sr min. (mm)	0.25
Differential Travel sd max. (mm)	0.05

Type **1S21** : Telescopic Built-In

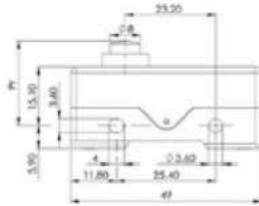
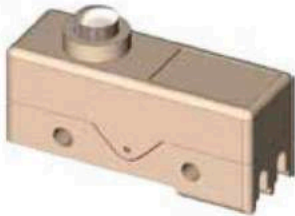

Actuating Force Fa max. (N)	5.0
Release Force Fr min. (N)	2.0
Free Position Pr (mm)	21.7 ± 0.6
Operating Position Pa (mm)	21.3 ± 0.3
Over-Travel sr min. (mm)	1.2
Differential Travel sd max. (mm)	0.06

Type **1SP21** : Telescopic Built-In with Protective Sleeve

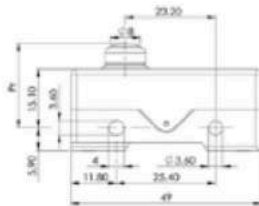
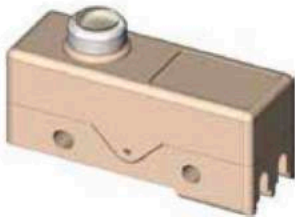

Actuating Force Fa max. (N)	5.0
Release Force Fr min. (N)	2.0
Free Position Pr (mm)	21.7 ± 0.6
Operating Position Pa (mm)	21.3 ± 0.3
Over-Travel sr min. (mm)	1.00
Differential Travel sd max. (mm)	0.06

Type **1S29** : Telescopic

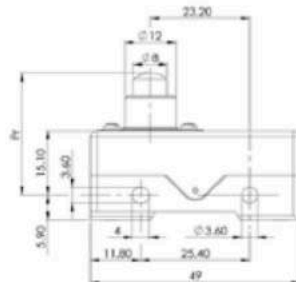
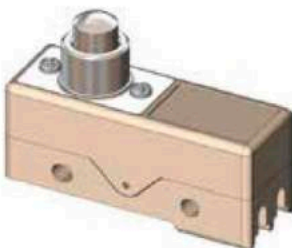

Actuating Force Fa max. (N)	5.0
Release Force Fr min. (N)	2.5
Free Position Pr (mm)	28.4 ± 0.6
Operating Position Pa (mm)	27.9 ± 0.3
Over-Travel sr min. (mm)	2.0
Differential Travel sd max. (mm)	0.05

Type 1A: Telescopic with Short Thread

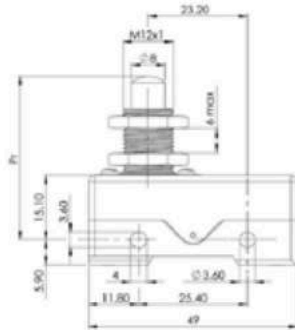
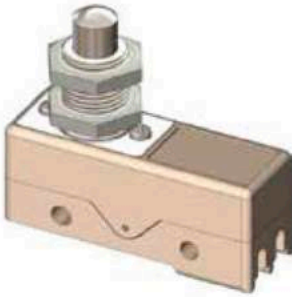

Actuating Force Fa max. (N)	5.0
Release Force Fr min. (N)	2.5
Free Position Pr (mm)	38.0 ± 0.6
Operating Position Pa (mm)	37.5 ± 0.3
Over-Travel sr min. (mm)	5.0
Differential Travel sd max. (mm)	0.05

Type 1A58: Telescopic with Thread

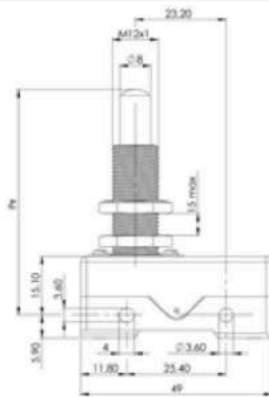
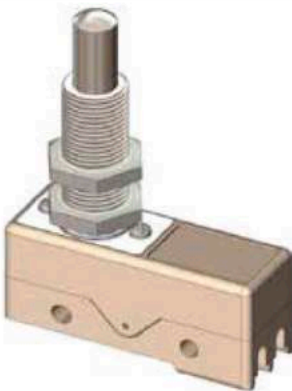

Actuating Force Fa max. (N)	5.0
Release Force Fr min. (N)	2.5
Free Position Pr (mm)	57.2 ± 1.0
Operating Position Pa (mm)	56.7 ± 0.3
Over-Travel sr min. (mm)	10.0
Differential Travel sd max. (mm)	0.10

Type 1BL: Telescopic with Roller

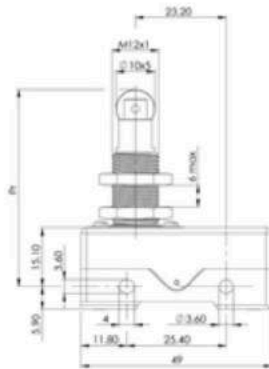
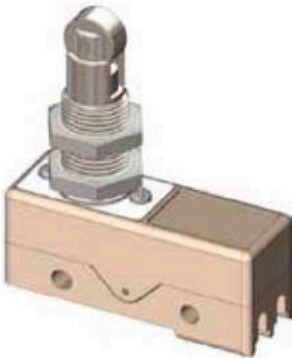

Actuating Force Fa max. (N)	5.0
Release Force Fr min. (N)	2.5
Free Position Pr (mm)	50.3 ± 0.6
Operating Position Pa (mm)	49.8 ± 0.3
Over-Travel sr min. (mm)	5.0
Differential Travel sd max. (mm)	0.05

Optional: stainless steel roller, transvers roller

Type 2A: Simple Lever - Direct Action -

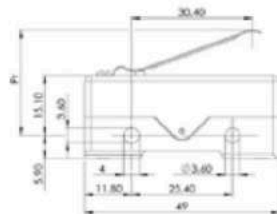
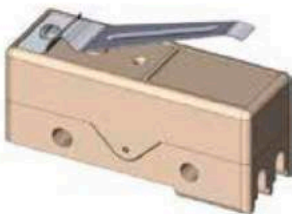

Actuating Force Fa max. (N)	2.5
Release Force Fr min. (N)	0.7
Free Position Pr (mm)	27.0 ± 2.0
Operating Position Pa (mm)	22.0 ± 2.0
Over-Travel sr min. (mm)	2.0
Differential Travel sd max. (mm)	0.80

Type **3A** : Simple Lever - Indirect Action -

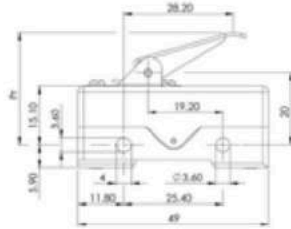
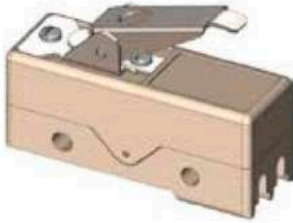

Actuating Force Fa max. (N)	4.5
Release Force Fr min. (N)	1.5
Free Position Pr (mm)	28.7 ± 1.5
Operating Position Pa (mm)	26.8 ± 1.5
Over-Travel sr min. (mm)	3.5
Differential Travel sd max. (mm)	0.50

Optional : lever mounted on opposite side

Type **4AL** : Simple Lever with Roller - Direct Action -

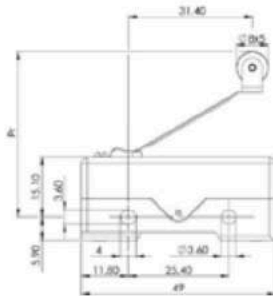
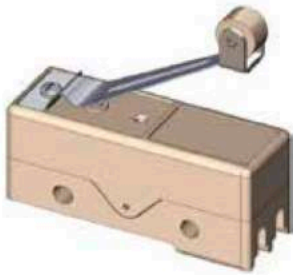

Actuating Force Fa max. (N)	2.5
Release Force Fr min. (N)	0.7
Free Position Pr (mm)	40.0 ± 2.0
Operating Position Pa (mm)	34.0 ± 2.0
Over-Travel sr min. (mm)	2.0
Differential Travel sd max. (mm)	0.80

Type **5AL** : Simple Lever with Roller - Indirect Action -

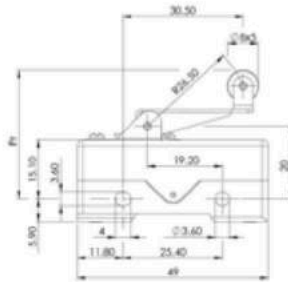
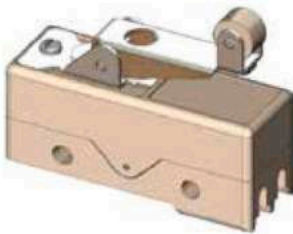

Actuating Force Fa max. (N)	4.5
Release Force Fr min. (N)	1.5
Free Position Pr (mm)	32.4 ± 1.5
Operating Position Pa (mm)	30.0 ± 1.5
Over-Travel sr min. (mm)	3.5
Differential Travel sd max. (mm)	0.50

Optional : lever mounted on opposite side, stainless steel roller, transvers roller

Type **6AL** : Simple Lever with Bending Roller - Indirect Action -

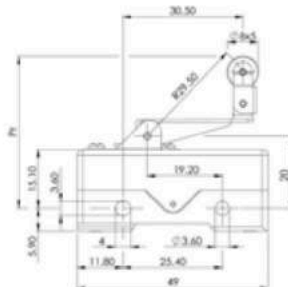
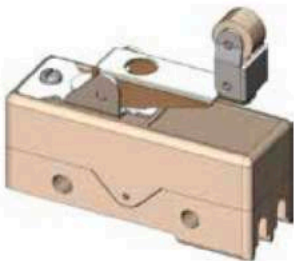

Actuating Force Fa max. (N)	4.5
Release Force Fr min. (N)	1.5
Free Position Pr (mm)	38.4 ± 1.5
Operating Position Pa (mm)	36.0 ± 1.5
Over-Travel sr min. (mm)	3.5
Differential Travel sd max. (mm)	0.50

Optional : lever mounted on opposite side, stainless steel roller, transvers roller

Electrical Circuit

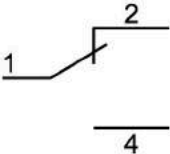
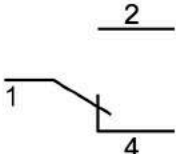
	Actuator Code	Circuit		Actuator Code	Circuit
Direct Action	0		Indirect Action	3A	
	1S21				
	1SP21				
	1S29				
	1A				
	1A58				
	1BL				
	2A				
	4AL				
	7A40				
	7AC				
	8AL40				

Protection Cover

A protection cover is available to protect the user from any contact with the terminals of the MP40 under power. The protection cover MP40-Z is fixed to the MP40 housing by means of a screw Parker.

MP40-0 + MP40-Z

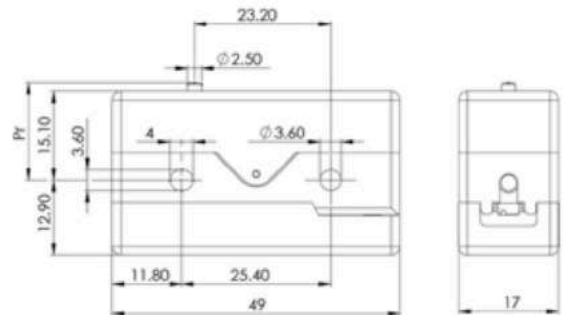
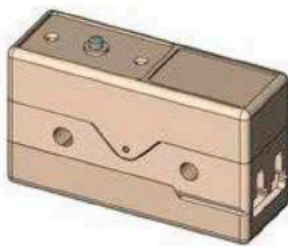

Ordering Information

	MP	4	0	-	5AL	+	MP40-Z
Housing							
4:	Screw Terminals						
5:	Solder Lugs						
Contact							
0:	Silver Contact						
1:	Gold Contact						
Actuator							
0:	Basic switch - Pin Button						
1S21	Telescopic Built-In						
1SP21	Telescopic Built-In with Protective Sleeve						
1S29:	Telescopic						
1A:	Telescopic with Short Thread						
1A58:	Telescopic with Thread						
1BL:	Telescopic with Roller						
2A:	Simple Lever - Direct Action						
3A:	Simple Lever - Indirect Action						
4AL:	Simple Lever with Roller - Direct Action						
5AL:	Simple Lever with Roller - Indirect Action						
6AL:	Simple Lever with Bending Roller - Indirect Action						
7A40:	Simple Adjustable Lever - Direct Action						
7AC:	Simple Adjustable Lever with Wire – Direct Action						
8AL40:	Simple Adjustable Lever with Roller - Direct Action						
Optional							
MP40-Z	Protection Cover						