



FLX3 Series

.171" Dia 6.0" Flexible Light Pipe



3mm Flexible Light Pipe available in different lengths from 2.0" to 12.0". Fit into a hole on 0.171" (4.34mm)

Product Specifications

- Materials:

- Fiber optic: \varnothing 1.5mm optical core, \varnothing 2.2mm polyethylene cable jacket

- Lens mount: optical grade acrylic

- LED mounts: for smd 22 & thr 22 - nylon 66, ul rating 94-v2, and for thr 5 22 - nylon 66, ul rating 94-hb

- Lens: polycarbonate, ul rating 94-v2

- Lens spacer: polypropylene

- Optical core ends polished to 10 microns

- Panel mounting hole: $.171" \pm .002$ ($4.34\text{mm} \pm 0.05$) on $1/4"$ (6.35mm) centers

- Panel thickness for sml 190: $1/32"$ (0.79mm) to $1/16"$ (1.60mm); smb 200 and smq 250: $1/16"$ (1.60mm) to $1/8"$ (3.48mm)

- Minimum bend radius: 40mm

- For added security for smb 200 and smq 250 use spc 040 spacer

- For best results use only narrow viewing angle non-diffused

- LEDs with output power greater than 100mcd

- U.S. and foreign patents issued

- The flexible fiber-optic is Polymethyl-Methacrylate Resin (core) and Fluorinated Polymer (cladding).

- The assembly can be stored and operated from -55C to $+77\text{C}$ (-67F to 170F).

- It should be noted that at lower temperatures flexibility (and ability to resist fracture) of the plastics is decreased.

- Fit's SMB 200, SML 190 and SMQ 250 Series (sold separately)

- SMB 200 lens and SMQ 250 lens use SPC 040 spacer (sold separately)

- Fit's the following LED mounts: SMD22, THR22 and THR522 (sold separately)

- Compliant with RoHS and REACH requirements

Ordering Data

Lite pipe assembly ordering code (example): **FLX3 XX**



↓

Length	
Length Code	Actual Length
02	2.0"
04	4.0"
06	6.0"
08	8.0"
12	12.0"
Custom lengths available upon request	

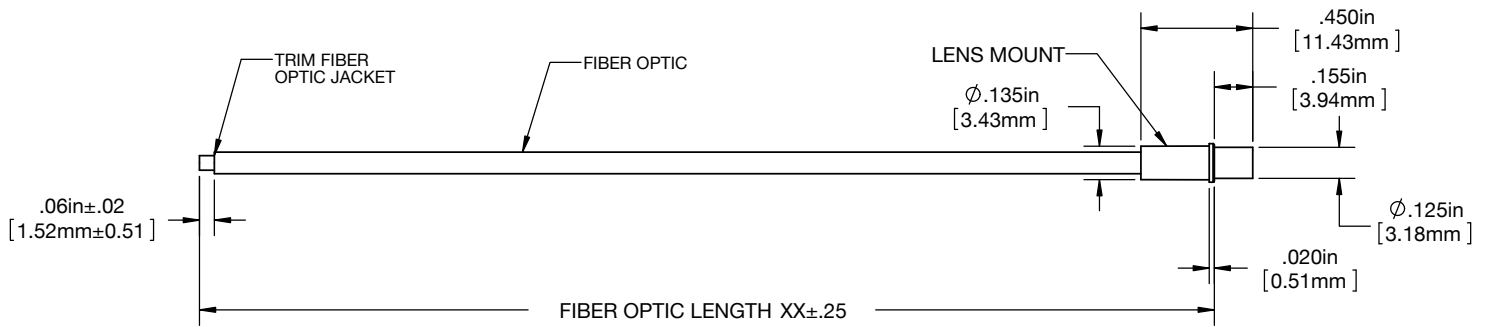
Product Dimensions

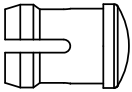
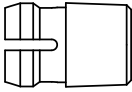
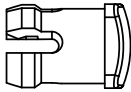

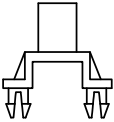
Lens (Order Separately)		
		
SMB 200	SML 190	SMQ 250

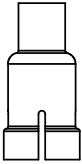
Mounting Options (Order Separately)		
		
SMB 22	THR 22	THR 5 22

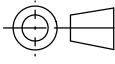
Dimensions Style Inches [MM] General Tolerances Unless Otherwise Specified		
	Inches	Length
.X	$\pm .020$	$\pm .508$
.XX	$\pm .015$	$\pm .381$
.XXX	$\pm .005$	$\pm .127$
Angle $\pm 1^\circ$		
Break All Corners And Sharp Edges .030 Max		
 Third Angle Projection		

Product Dimensions

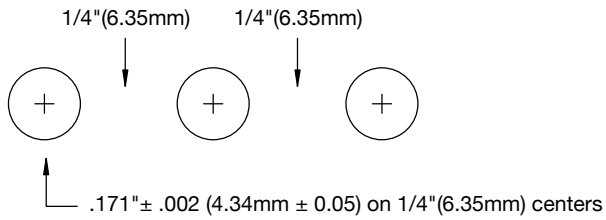

SML 190

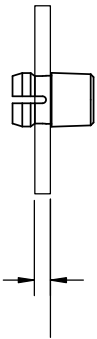

1/32" (0.79mm)
to
1/16" (1.60mm)

SMB 200 and SMQ 250

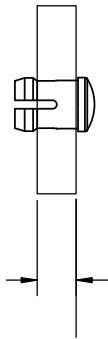

1/16" (1.60mm)
to
1/8" (3.48mm)

Compliances and Approvals

