

CMD95-21

1.9mm Sub-Minature Surface Mount LED



Available in multiple single color options and a 25 degree viewing angle. Gull wing, Yoke or Z-bend lead configurations with high intensity light output and a clear non-diffused lens.

Key Features

- Tape and reel packaged for high-speed auto insertion
- Convection and vapor-phase reflow compatible
- Compact form enables high density placement
- Gull wing or Z-bend lead configuration
- Consistent high brightness
- 1000 pieces per reel
- Stringent process controls assure quality
- Extensive qualification testing to meet strictest requirements
- Designed to permit easy post-reflow solder joint inspection
- Compliant with RoHS

Package Dimension

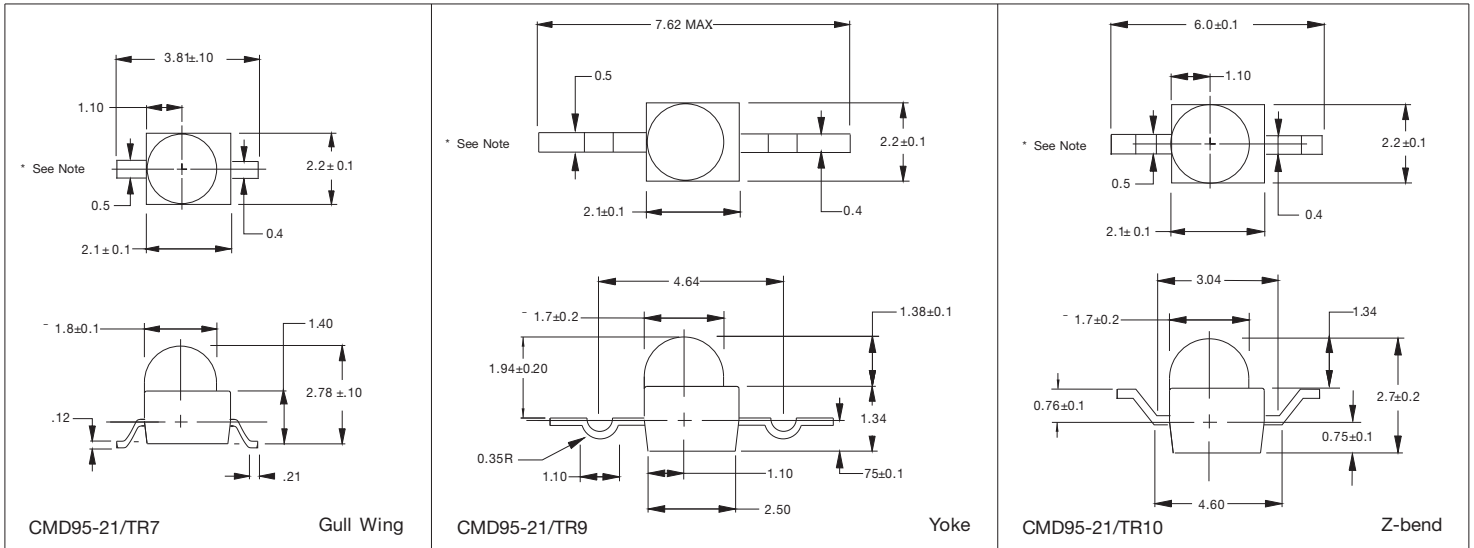

* Cathode for VGC/VYC/VRC Anode for SRC

All dimensions in mm

Tape and Reel

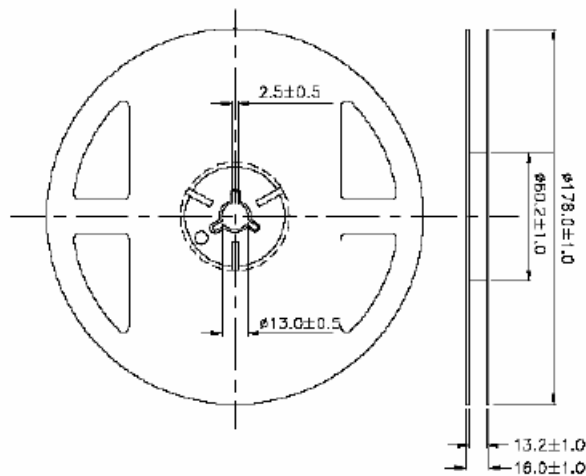
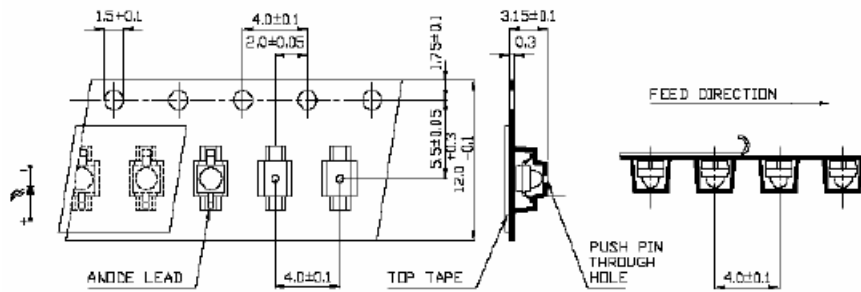

Product Specifications

Electrical / Optical Characteristics and Curves at Ta= 25°C

Part Number	Emitted Color	Lens Color	Luminous Intensity		Forward Voltage		Viewing Angle (degrees)	Peak Wavelength (nm)
			Min. (mcd)	Typ. (mcd)	Typ. (V)	Max. (V)		
CMD95-21VYC/TR7	Yellow	Clear	16.0	25.0	2.0	2.8	25	585
CMD95-21VRC/TR7	Red	Clear	16.0	25.0	2.0	2.8	25	640
CMD95-21SRC/TR7	Red	Clear	60.0	100.0	1.7	2.4	25	660
CMD95-21VGC/TR10	Green	Clear	11.5	19.5	2.1	2.8	25	570
CMD95-21VYC/TR10	Yellow	Clear	16.0	25.0	2.0	2.8	25	585
CMD95-21VRC/TR10	Red	Clear	16.0	25.0	2.0	2.8	25	640
CMD95-21SRC/TR10	Red	Clear	60.0	100.0	1.7	2.4	25	660

Absolute Maximum Ratings at Ta= 25°C

Units		Green	Yellow	Red
mW	Power Dissipation	105	105	100
°C	Storage	-40 to +100	-40 to +100	-40 to +100
°C	Operating Temperature	-40 to +85	-40 to +85	-40 to +85
mA	Peak Forward Current (1µs @ 10% duty cycle)	150	150	150
V	Reverse Voltage (IR=100µA)	5.0	5.0	5.0
Seconds	Lead Solder Time @ 260°C	5	5	5
mA	Forward Current	25	30	30

Compliances and Approvals

